



THE UNIVERSITY
of EDINBURGH

Usher Building Opening **2025**

Edinburgh | 26 June 2025



Ground floor

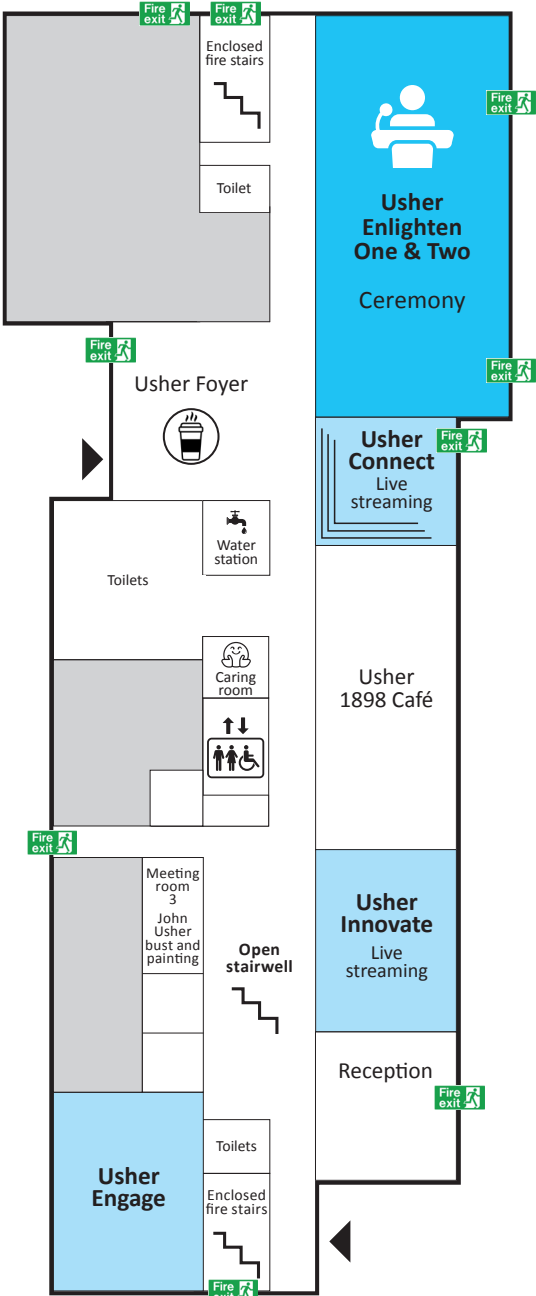

First floor

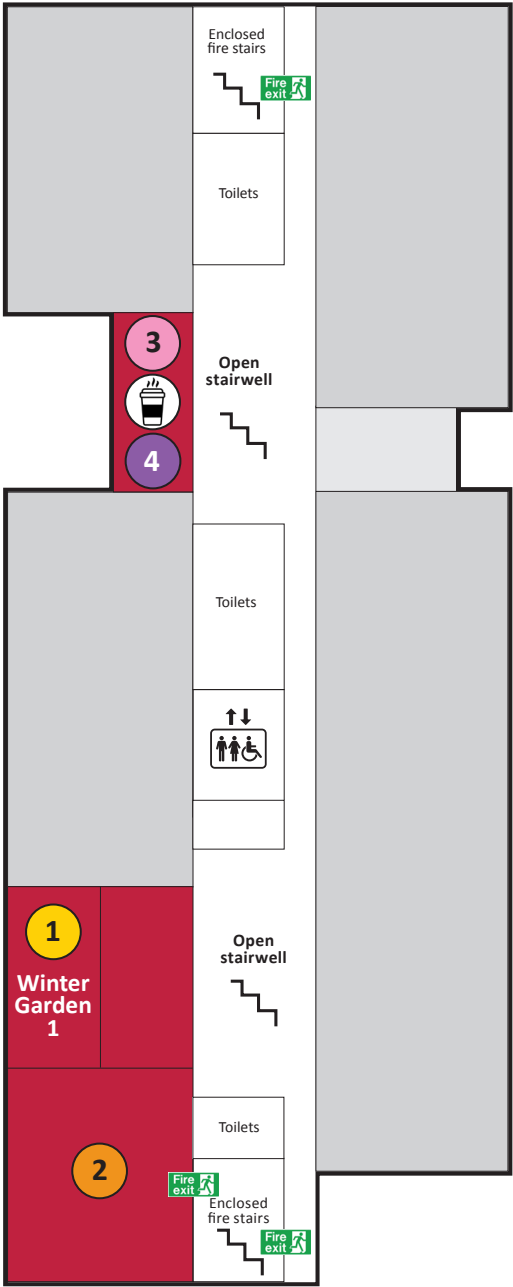

Key

- Showcase
- 1 Medical Informatics
- 2 Resolution Therapeutics
- 3 Engineering Health: CHAI
- 4 Biomedicine, Self and Society
- Ceremony
- Live streaming
- Refreshment point

Second floor

Third floor

- 5 Advanced Care Research Centre
- 6 Population Health and Training
- 7 Cohort Studies and Evidence Synthesis
- 8 Edinburgh Clinical Trials Unit & ACCORD
- 9 Global Health
- 10 Public Involvement, Engagement and Innovation
-  Refreshment point



Full details
of programme,
posters & exhibits

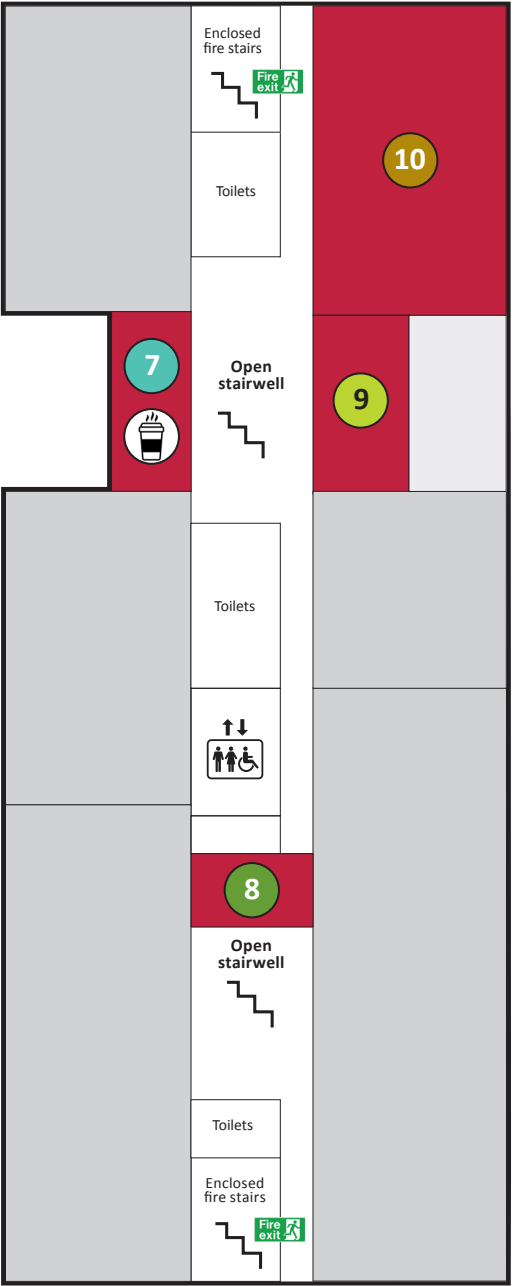
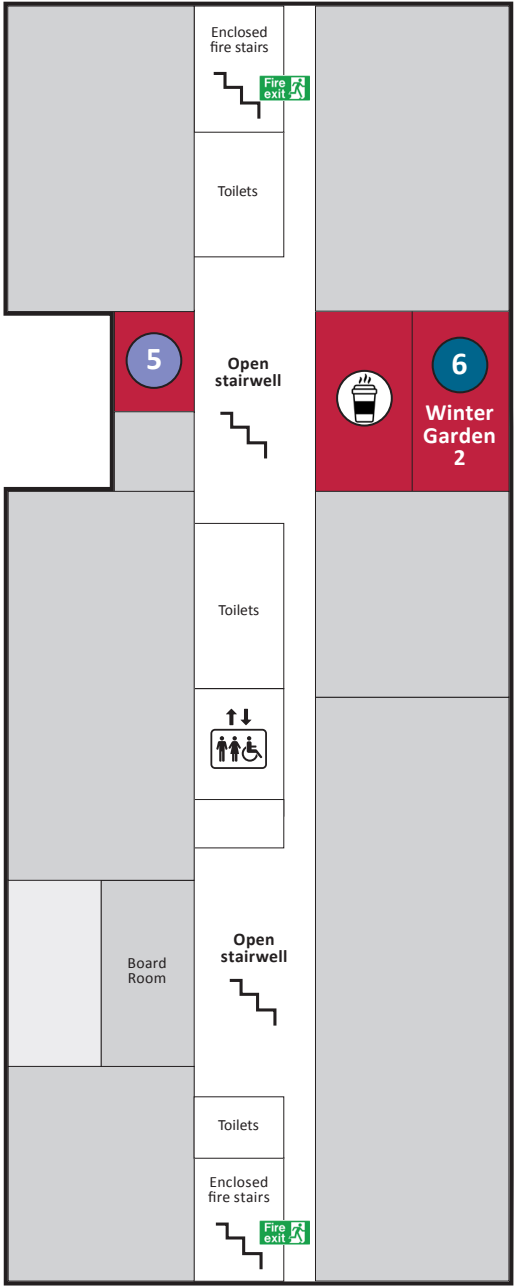

the difference we make

Our innovative thinking, world-class research and teaching, and strong strategic partnerships help to shape and inform advances in health and care across the globe.

To discover the impact we have, and hear about how we are making a difference locally and globally, please explore 'The difference we make' on our website.



Find out more

Large scale data, large scale impact



Clinical trials and cohort studies



Public perspectives, ethics & integrity



Collaborating across disciplines



Enhancing population health



Strengthening global health



Amplifying clinical connections



Accelerating innovation



Usher Connects

The University of Edinburgh's Usher Institute holds Usher Connects events to explore how working with people, populations and their data can transform health in society.

Full programme of Usher Connects events, including the Usher Annual Lecture.



THE UNIVERSITY
of EDINBURGH

Usher
Institute

Usher Institute Annual Lecture & Showcase

Thursday 25 Sept 2025 | McEwan Hall, Edinburgh

Join us for our keynote lecture
complemented by a showcase of
work from across the Usher Institute.



Dr David B. Nash
Thomas Jefferson
University, Philadelphia

'Post pandemic population
health in the USA and beyond'